

PERMIT

CITY OF NAPOLEON - BUILDING DEPARTMENT

255 West Riverview Avenue, Napoleon, Ohio 43545 - 419-592-4010

Permit No. 687-77 Issued April 1, 1977
 Job Location 410 Fillmore St.
 Lot A. Corey's Alteration
 Issued By Ronald D. Sonnenberg
 Owner Napoleon Products 592-7916
 Address 410 Fillmore St.
 Agent Harold Bostelman 592-2383
 Address 618 Park St.
 Description of Use New 200 amp service
entrance & wiring.
 Residential _____
 Commercial _____ Industrial XXX
 New _____ Add'n _____ Alter XXX Remodel _____
 Mixed Occupancy _____
 Change of Occupancy _____
 Estimated Cost \$ 4,500.00

| FEES | BASE | PLUS | TOTAL |
|--|-------------------|---------------------|------------|
| | BUILDING | | |
| <input checked="" type="checkbox"/> ELECTRICAL | \$18.00 | \$5.50 | \$23.50 |
| <input type="checkbox"/> PLUMBING | | | |
| <input type="checkbox"/> MECHANICAL | | | |
| <input type="checkbox"/> DEMOLITION | | | |
| <input type="checkbox"/> ZONING | | | |
| <input type="checkbox"/> SIGN | | | |
| WATER TAP | | | |
| SEWER TAP | | | |
| TEMP. ELECT. | | | |
| ADDITIONAL PLAN REVIEW | Struct. _____ hrs | Elect. <u>0</u> hrs | <u>-0-</u> |
| TOTAL FEES..... | | | \$23.50 |
| LESS MIN. FEES PAID <u>4/1/77</u> date | | | \$23.50 |
| BALANCE DUE..... | | | <u>-0-</u> |

ZONING INFORMATION

N/A

| district | lot dimensions | area | front yd | side yds | rear yd |
|----------|----------------|---------------|-----------|--------------------------|-----------|
| max hgt | no pkg spaces | no ldg spaces | max cover | petition or appeal req'd | date appr |

WORK INFORMATION:

Size: Length 48' Width 20' Stories 1 Ground Floor Area 960sq'
 Height _____ Building Volume (for demo. permit) _____ cu. ft.
 Electrical: New 200 amp electric service entrance & wiring.
 Plumbing: None
 Mechanical: None
 Sign: _____ Dimensions _____ Sign Area _____
 Additional Information: Shall conform to N.E.C. 1975 Edition NFPA 70.

Date 4-6-77 Applicant Signature Harold Bostelman
 owner-agent

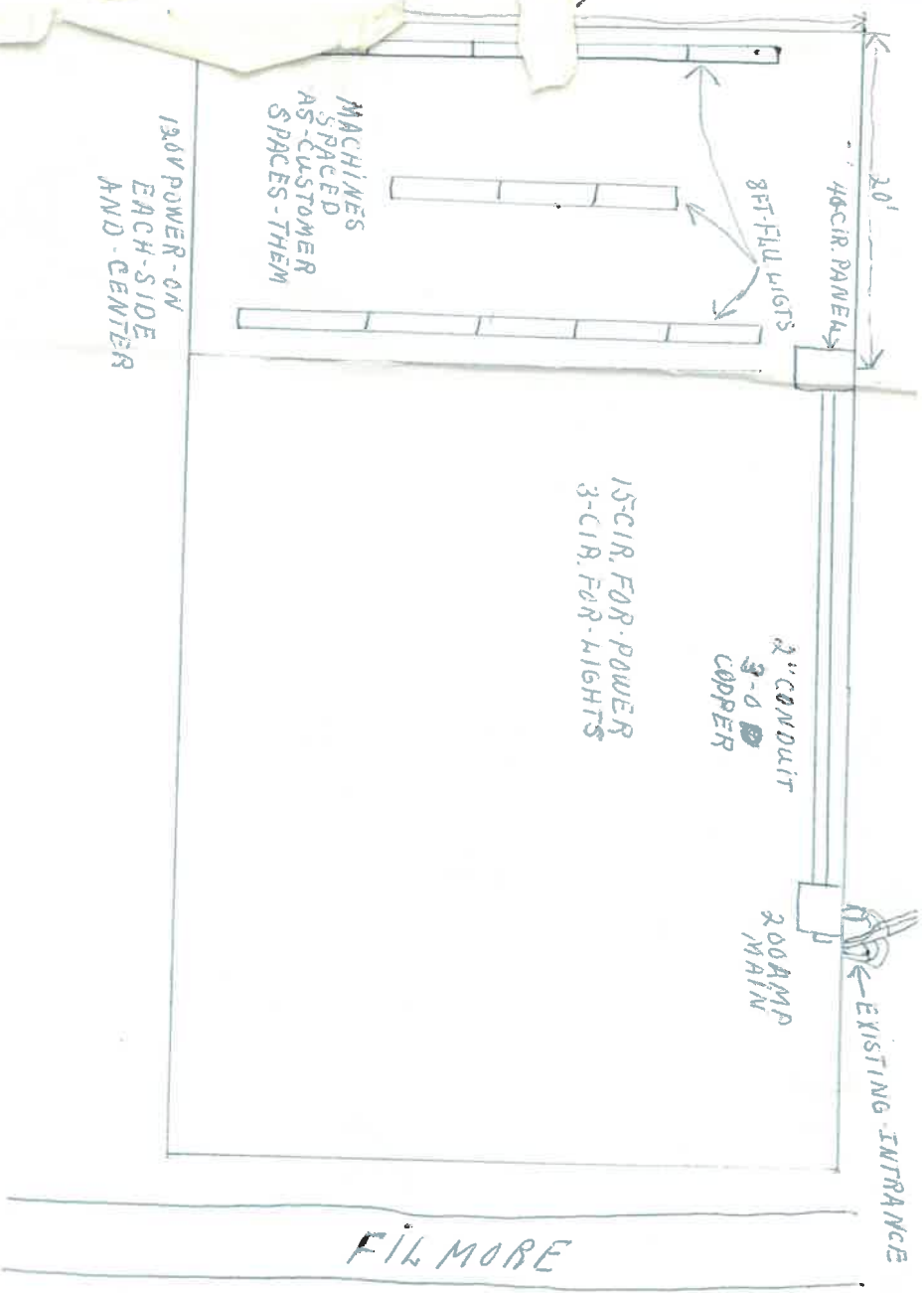

FILMORE

**CITY OF NAPOLEON
BUILDING DEPT.**

Plan Approval

By ALH Date 3-31-27

135 AMPS,
ON SINGLE PHASE
 $\frac{1}{4}$ HP to $\frac{1}{2}$ HP MOTORS
20 AMPS ON LIGHTS

